

REVISIONS		DATE	APPROVED
REV	DESCRIPTION		
1	-	-	

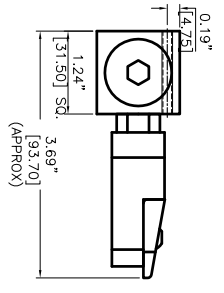

	THREADS	FINISH	AL/SS304/SS316L
	PROJECTION	FINISH	-
REQUIREMENTS - FINISHES OTHER FINISHES SPECIFIED BY THE CUSTOMER:			
1. DIMENSIONS ARE UNLESS OTHERWISE SPECIFIED 2. DIMENSIONS AND TOLERANCES IN ACCORDANCE WITH ASME Y14.5 (1982) 3. MAKE FINISH 125 MICRO INCH RMS & BREAK SHARP CORNERS .005 TO .015 4. HOLES IN ACCORDANCE WITH AND 10397			
LIMITS 1. LINEAR DIMS: .001" = .005 .002" = .010 .005" = .020 2. ANGLES = ± 1/2° 3. ROUNDOFF .010 MIN			
CONTRACT NUMBER	CLIENT	DATE	REV
	CONTRACTOR	28/09/2014	1
DRAWN	DATE	DATE	DATE
CHKD	28/09/2014	28/09/2014	28/09/2014
DES	ASSEMBLY	ASSEMBLY	ASSEMBLY
PROD	QA	QA	QA
STRESS	MANUFACTURING	MANUFACTURING	MANUFACTURING
THERMAL	WELDING	WELDING	WELDING
MECHANICAL	ELECTRICAL	ELECTRICAL	ELECTRICAL
SIZE	DWG NO	REV	REV
SCALE	46006HF+47011	1	1
1:1	CAD NO	SHEET	OF
	HR/PLAN-04-FJ	1	1
NEX FLOW AIR PRODUCTS CORP. 10520 YONCE STREET, UNIT 359-220, RICHMOND HILL, ON L4C 3C7 TEL: (416) 410-1313 & FAX: (416) 410-1806 www.nex-flow.com			
OUTLINE DRAWING OF 6 PORT HIGH FLOW MANIFOLD WITH 47011 FLATJET			

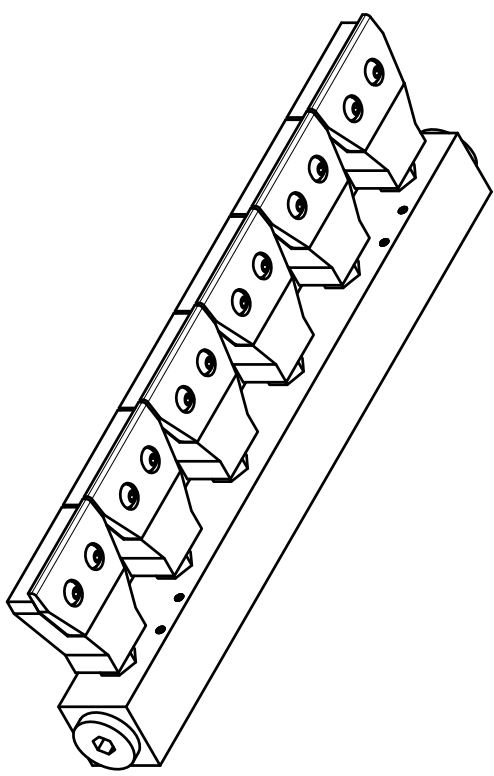
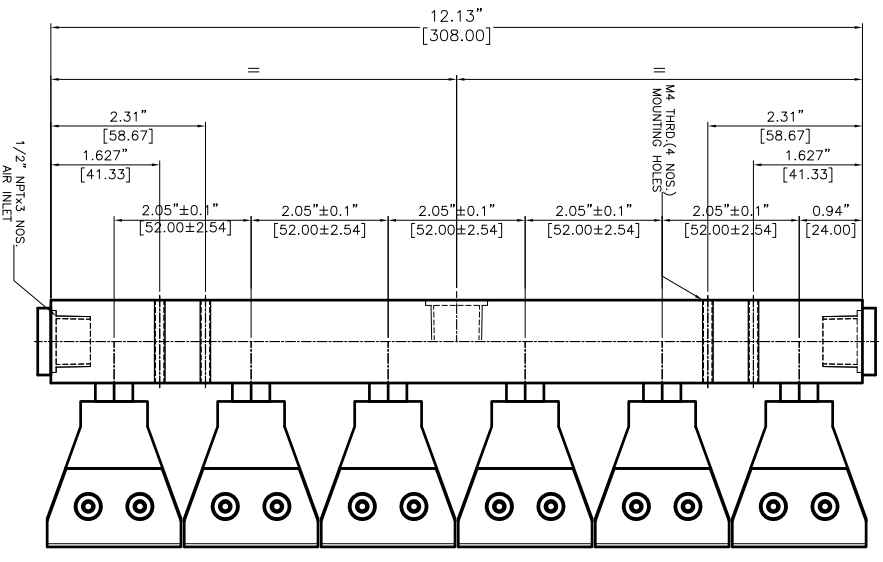