

- NOTES:
- 1 ALL DIMENSIONS SHOWN ARE FINISH OPERATIONAL DIMENSIONS WHICH INCLUDE RESIDUAL COATINGS UNLESS OTHERWISE SPECIFIED.
  - 2 PART TO BE PACKED PROPERLY TO AVOID ANY DAMAGE WHILE SHIPPING & HANDLING.
  - 3 ALL HORIZONTAL DIMENSIONS ARE SYMMETRICAL ABOUT CENTER LINE UNLESS OTHERWISE SPECIFIED.

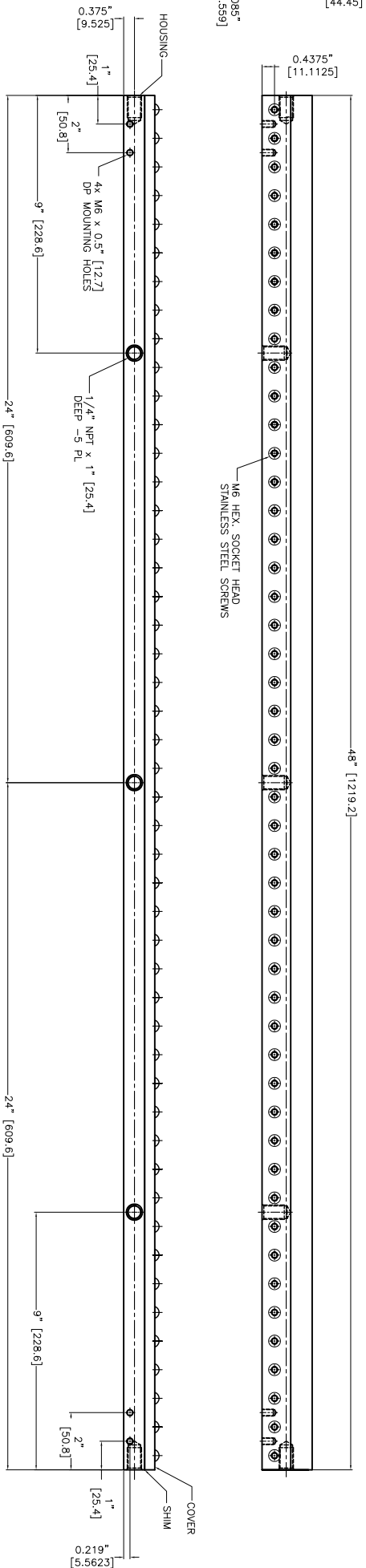
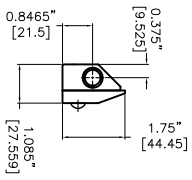

	<b>TEMP ANGLE PROTECTION</b> 	<b>REQUIREMENTS - FINISHES</b> OTHER FINISHES SPECIFIED 1. FINISH AS PER MANUFACTURER'S RECOMMENDATION 2. DIMENSIONS AND TOLERANCES IN ACCORDANCE WITH ANSI Y14.5 (1982) 3. MACHINE FINISH 125 MICRO INCH RMS 4. BREAK SHARP CORNERS .005 TO .015
	<b>MATERIAL</b> SS 304	<b>CONTRACT NUMBER</b> CLIENT CONTRACTOR DRAWN DESIGNED DATE APPROVED CHECKED DATE
<b>FINISH</b> -	<b>STRESS</b> TENSILE YIELD ELONGATION ELECTRICAL	<b>MANUFACTURING</b> MATERIALS DIMENSIONS ELECTRICAL
<b>PART NO.</b> NEXT ASSEMBLY USED ON QTY PER PART NO.	<b>REVISIONS</b> NO. DATE BY 1. LINEAR DIMS .005 .010 .020 .030 .040 .050 .060 .070 .080 .090 .100 .110 .120 .130 .140 .150 .160 .170 .180 .190 .200 .210 .220 .230 .240 .250 .260 .270 .280 .290 .300 .310 .320 .330 .340 .350 .360 .370 .380 .390 .400 .410 .420 .430 .440 .450 .460 .470 .480 .490 .500 .510 .520 .530 .540 .550 .560 .570 .580 .590 .600 .610 .620 .630 .640 .650 .660 .670 .680 .690 .700 .710 .720 .730 .740 .750 .760 .770 .780 .790 .800 .810 .820 .830 .840 .850 .860 .870 .880 .890 .900 .910 .920 .930 .940 .950 .960 .970 .980 .990 1.000	<b>MANUFACTURING</b> MATERIALS DIMENSIONS ELECTRICAL
<b>FINISH</b> -	<b>REVISIONS</b> NO. DATE BY 1. LINEAR DIMS .005 .010 .020 .030 .040 .050 .060 .070 .080 .090 .100 .110 .120 .130 .140 .150 .160 .170 .180 .190 .200 .210 .220 .230 .240 .250 .260 .270 .280 .290 .300 .310 .320 .330 .340 .350 .360 .370 .380 .390 .400 .410 .420 .430 .440 .450 .460 .470 .480 .490 .500 .510 .520 .530 .540 .550 .560 .570 .580 .590 .600 .610 .620 .630 .640 .650 .660 .670 .680 .690 .700 .710 .720 .730 .740 .750 .760 .770 .780 .790 .800 .810 .820 .830 .840 .850 .860 .870 .880 .890 .900 .910 .920 .930 .940 .950 .960 .970 .980 .990 1.000	<b>MANUFACTURING</b> MATERIALS DIMENSIONS ELECTRICAL
<b>FINISH</b> -	<b>REVISIONS</b> NO. DATE BY 1. LINEAR DIMS .005 .010 .020 .030 .040 .050 .060 .070 .080 .090 .100 .110 .120 .130 .140 .150 .160 .170 .180 .190 .200 .210 .220 .230 .240 .250 .260 .270 .280 .290 .300 .310 .320 .330 .340 .350 .360 .370 .380 .390 .400 .410 .420 .430 .440 .450 .460 .470 .480 .490 .500 .510 .520 .530 .540 .550 .560 .570 .580 .590 .600 .610 .620 .630 .640 .650 .660 .670 .680 .690 .700 .710 .720 .730 .740 .750 .760 .770 .780 .790 .800 .810 .820 .830 .840 .850 .860 .870 .880 .890 .900 .910 .920 .930 .940 .950 .960 .970 .980 .990 1.000	<b>MANUFACTURING</b> MATERIALS DIMENSIONS ELECTRICAL

**NEX FLOW AIR PRODUCTS CORP.**  
 10520 YONCE STREET, UNIT 259-220 RICHMOND HILL, ON L4C 3C7  
 TEL: (416) 410-1313 & FAX: (416) 410-1806 [www.nex-flow.com](http://www.nex-flow.com)

**OUTLINE DRAWING OF**  
**48" X-STREAM AIR BLADE AIR KNIFE**

TITLE: 10048XS  
 DATE CODE: 10048XS  
 DIM NO: 10048XS  
 SCALE: 1:1  
 CDG NO: XKKS-48  
 SHEET 1 OF 1